

ISOMETRIC

NTS

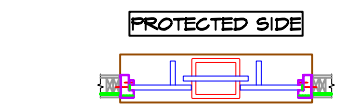

PROTECTED SIDE

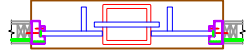

THREAT SIDE

PLAN

NTS

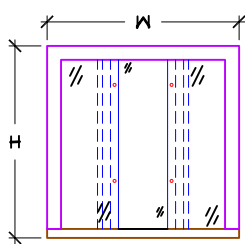

ELEVATION

REQUIRED FINISH OPENING = NTS

WIDTH - 3-3/4"

HEIGHT - 1-7/8"

TRANSACTION WINDOW WITH VERTICAL VOICE PORT. SPECIFY LEVEL OF PROTECTION. SIZES AVAILABLE UP TO 8'w x 5'h.

NOTES:

- 1 12 GAUGE STEEL C-SHAPE BALLISTIC CAPTURE FRAME W/ POWDER COAT FINISH
- 2 16 GAUGE STAINLESS STEEL DEAL TRAY
- 3 CLEAR BULLET RESISTANT MATERIALS SPECIFY UL 752 LVLS I THRU III
- 4 NATURAL VOICE PORT FOR SOUND TRANSMISSION INCLUDES BACK PLATE THAT OVERLAPS MIN OF 2"
- 5 BALLISTIC LINED COUNTER TOP MADE OF PLASTIC LAMINATE W/ PHENOLIC BACKING MULTIPLE COLORS (STAINLESS STEEL COUNTER ALSO AVAILABLE UPON REQUEST)
- 6 MOUNTING HOLES ON PROTECTED SIDE OF THE FRAME FOR ADDED SECURITY

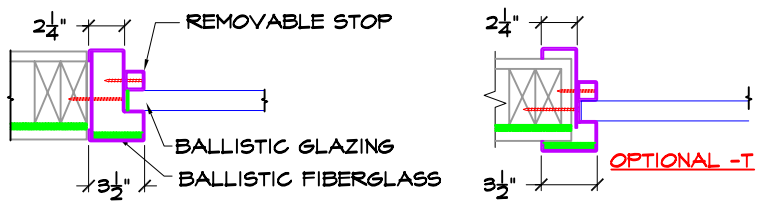

A STEEL WINDOW JAMB

SIM @ HEAD

NTS

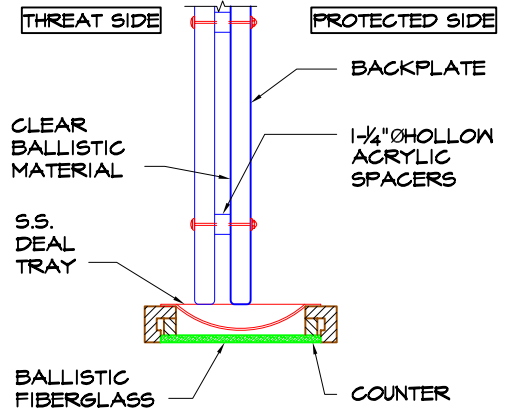

B SECTION @ DEAL TRAY

NTS

TW AVP-ST-C (TW= TRANSACTION WINDOW, A= TYPE OF VOICE PORT, ST= FRAME MATERIAL, C= FRAME TYPE)

(ADDITIONAL OPTIONS REPLACE AS NECESSARY)  
 FRAME MATERIAL OPTIONS- ST= STEEL, SS= STAINLESS STEEL  
 FRAME TYPE OPTIONS- C= C-SHAPE, T= TELESCOPING



MODEL # TWVVP-ST  
 BULLET RESISTANT TRANSACTION WINDOW  
 WITH VERTICAL VOICEPORT

K:\DRAWINGS\WEB DRAWINGS\TWVVP-ST-C.dwg